



Horizontal Multistage Centrifugal Pumps



SHINDO HAS CONSTANTLY DEVELOP THE CREDIBILITY TO SERVE THE INDUSTRY EFFICIENTLY.

SHINDO IS COMMITTED TO PROVIDE HIGH VALUE-ADDED PRODUCTS IN MINIMUM LEAD-TIME AND AT COST EFFECTIVE PRICING, TO HELP CUSTOMERS ACHIEVE ZERO DOWNTIME, PRODUCTION TARGET AND HELP ENHANCE A SAFER ENVIRONMENT.



HORIZONTAL MULTISTAGE CENTRIFUGAL PUMPS

PAGE CONTENTS

01	APPLICATION MODEL CODE
02	CONSTRUCTION DESIGN
03	GENERAL ARRANGEMENT DRAWING
04	SELECTION CHART
05	TECHNICAL DATA (HSI2-C)
06	TECHNICAL DATA (HSI4-C)
07	TECHNICAL DATA (HSI8-C)
08	TECHNICAL DATA (HSI8-BC)
09	TECHNICAL DATA (HSI12-C)
10	TECHNICAL DATA (HSI12-BC)
11	TECHNICAL DATA (HSI16-C)
12	TECHNICAL DATA (HSI20-C)

Application

Shindo Horizontal Multistage Centrifugal Pumps, HSI-C Series are design for the applications as below:

- ▣ Cooling Water System
- ▣ Domestic Water Supply
- ▣ Industrial Cleaning
- ▣ Agriculture
- ▣ Pesticide Dosing System
- ▣ Environmental Protection
- ▣ Water Treatment
- ▣ Boosting & Circulation System

Performance range for HSI-C series:

- ▣ Max. Capacity (Q) = 28m³/hr
- ▣ Max. Head (H) = 60m
- ▣ Max. Operating Pressure = 10 bar
- ▣ Max. Ambient Temperature = 50°C
- ▣ Liquid Temperature:
 - ▶ Standard Design = -15°C to +70°C (Max)
 - ▶ Hot Water Design = -15°C to +110°C (Max)



Model Code

HSI 12 - 30 B C

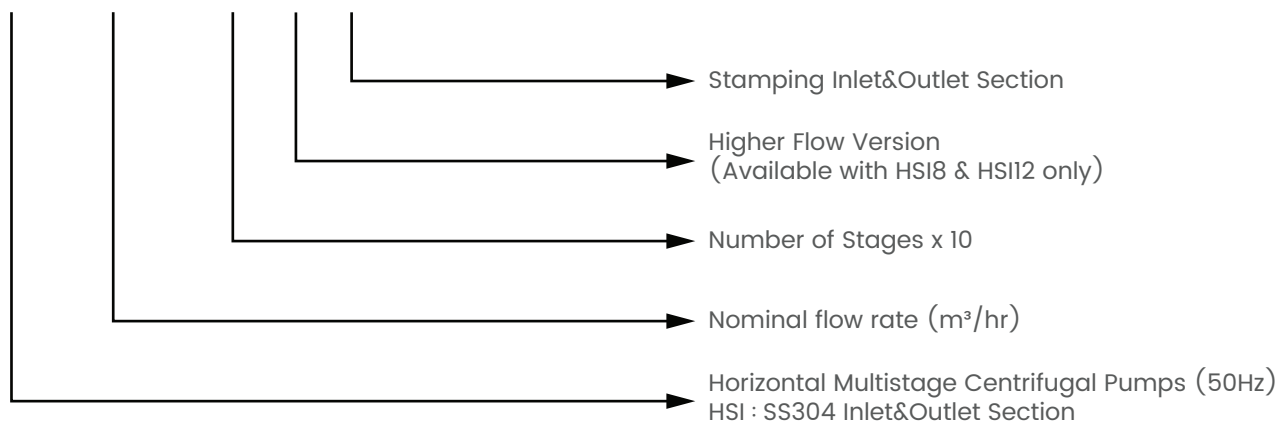

Construction Design

Hydraulic Parts

- Impeller and shaft are made up of stainless steel.
- For HSI Series, the suction and discharge head is made up of stainless steel (SS304).
- The standard material of mechanical seal is Graphite/SiC/EPDM.
- HS/HSI pump is design with axial suction and vertical discharge (Both are threaded).

Electric Motor

- The pump is coupled with totally enclosed, fan-cooled squirrel-cage aluminum casing motor built-in thermal overload units.
- Insulation Class: F
- Enclosure Class: IP55
- Speed: 2900RPM
- Standard Voltage: 1 x 220-240V, 50Hz
3 x 220-240V/380-415V, 50Hz
- Single phase motor is available up to 2.2kW only.

Material of Mechanical Seal

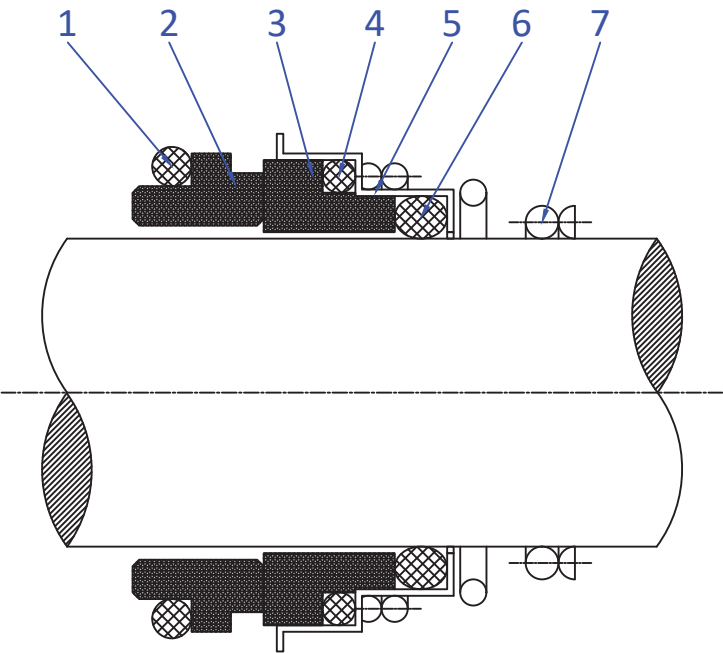

No.	Name	Qty	Material
1	O-Ring	1	EPDM
2	Stationary Seats	1	Silicon Carbide
3	Seal Faces	1	Graphite
4	O-Ring	1	EPDM
5	Seal Faces Base	1	Stainless Steel
6	O-Ring	1	EPDM
7	Spring	1	Stainless Steel

General Arrangement Drawing

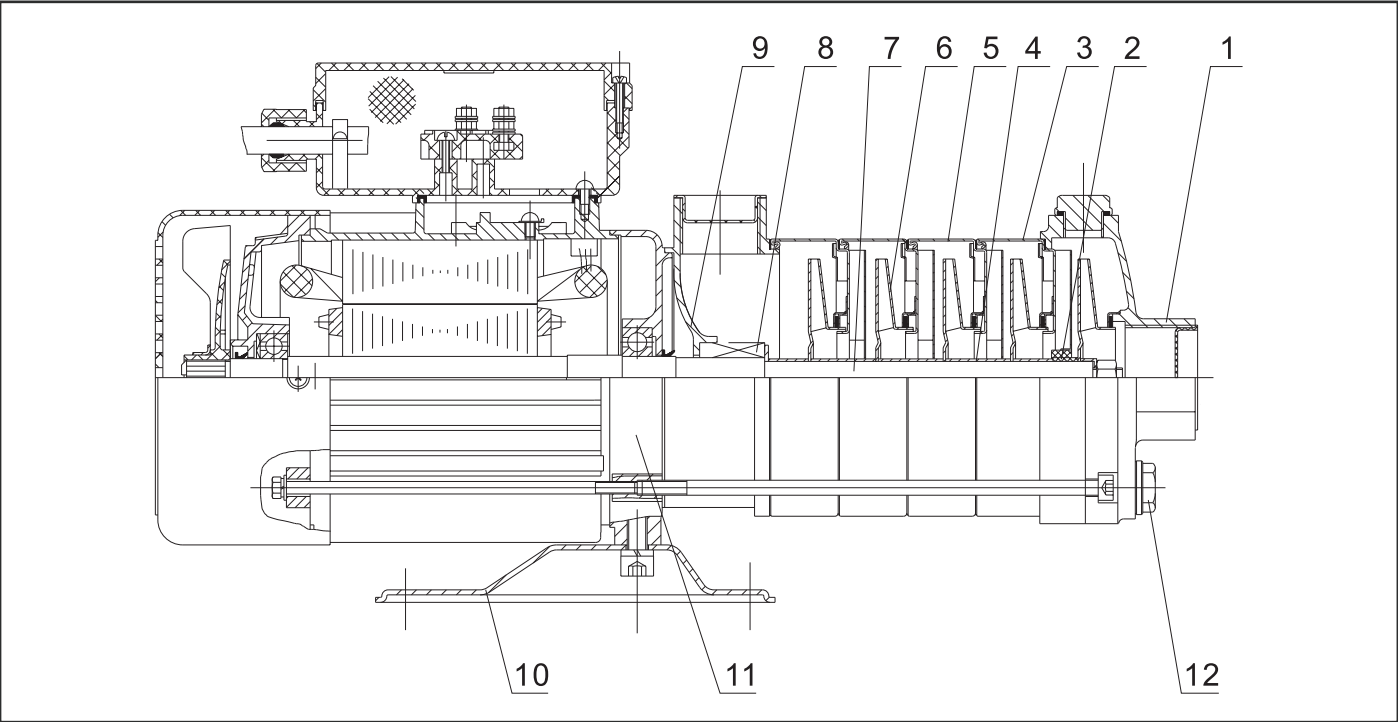

Part No.	Name	Material
2	Bearing Sleeve	Hard Alloy
3	Support Guide Vane	Stainless Steel (SS304)
4	Separating Sleeve	Stainless Steel (SS304)
5	Middle Section	Stainless Steel (SS304)
6	Impeller	Stainless Steel (SS304)
7	Shaft	Stainless Steel (SS304)
8	Mechanical Seal	Graphite/SiC/EPDM
10	Base Frame	A3 Steel
11	Front Cover	Aluminum Alloy
12	Plug	POM
HSI		
1	Suction Head	Stainless Steel (SS304)
9	Discharge Head	Stainless Steel (SS304)

*SS316 material is available on request.

Selection Chart

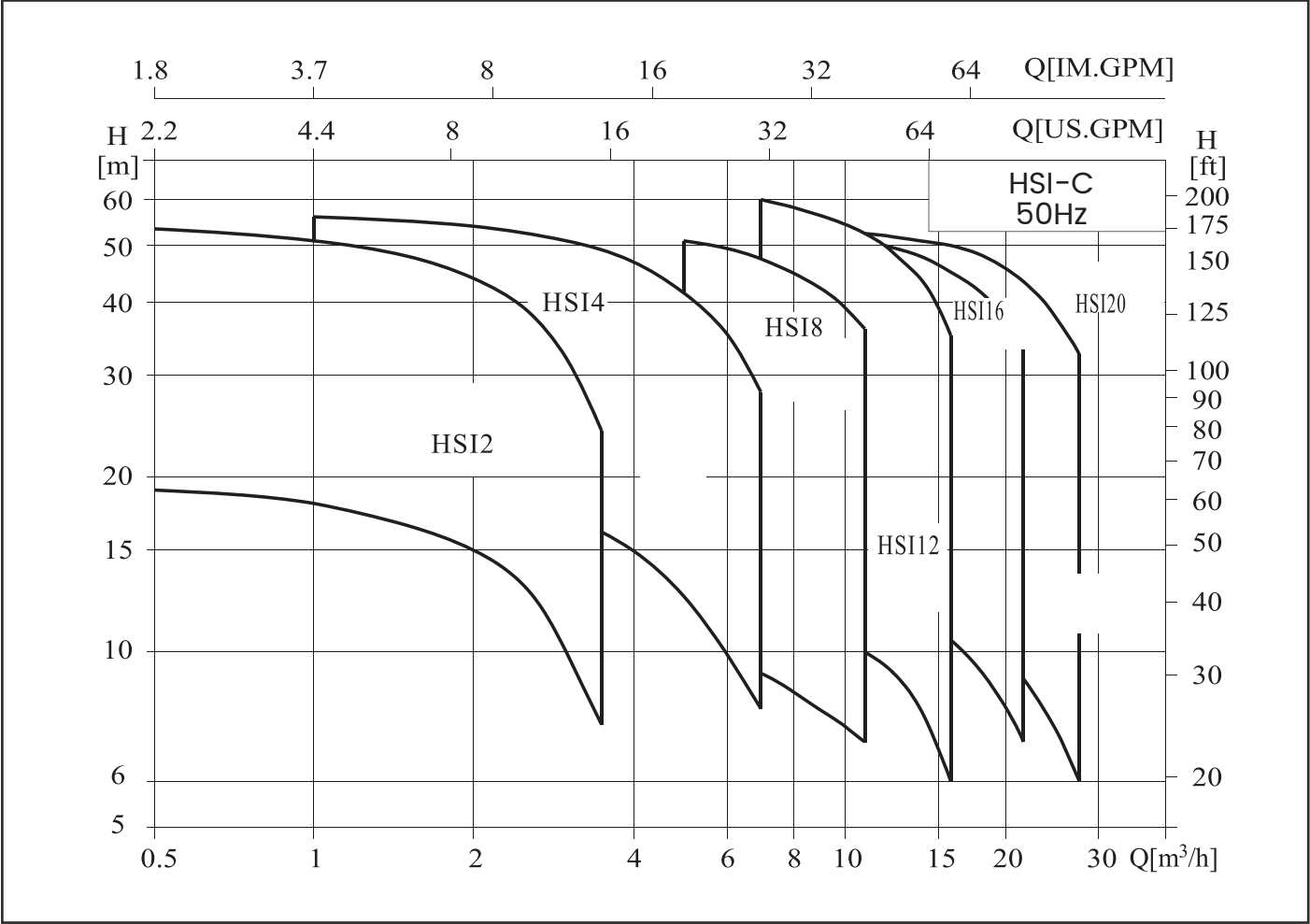

Technical Data (HSI2-C)

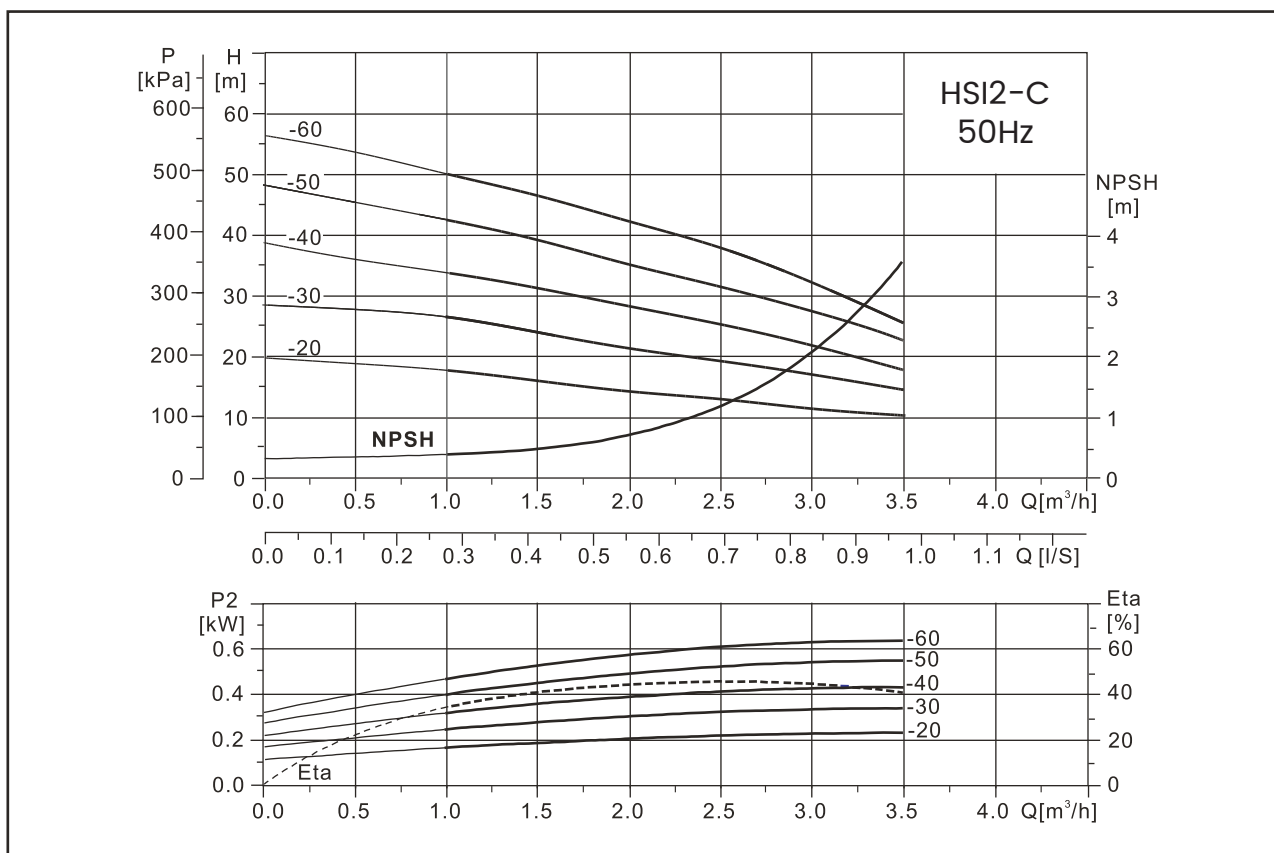

Performance Table

MODEL	Driving motor P_2 (kW)	Q (m^3/h)	1.0	1.5	2.0	2.5	3.0	3.5
HSI2-20C	0.37	H (m)	18	16	14	13	11	10
HSI2-30C	0.37		27	24	21	20	17	14
HSI2-40C	0.55		35	32	28	26	23	17
HSI2-50C	0.55		43	40	35	33	28	22
HSI2-60C	0.75		50	48	42	38	32	25

Dimension & Weight

MODEL	SIZE (mm)								Weight (kg)
	Single Phase				Three Phase				
	L1	L2	L3	H	L1	L2	L3	H	
HSI2-20C	342	103	92	189	342	103	92	192	7.5
HSI2-30C	360	121	110	189	360	121	110	192	8
HSI2-40C	378	139	128	189	378	139	128	192	9
HSI2-50C	396	157	146	189	396	157	146	192	10
HSI2-60C	414	175	164	189	414	175	164	192	11

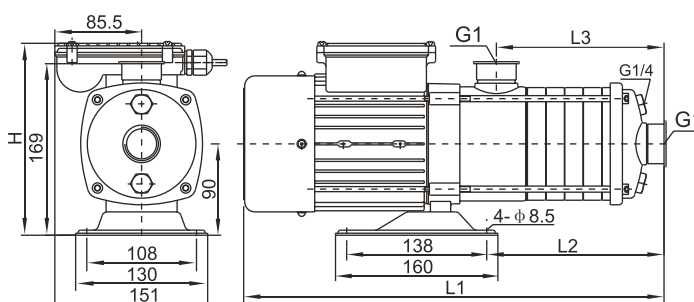

Technical Data (HSI4-C)

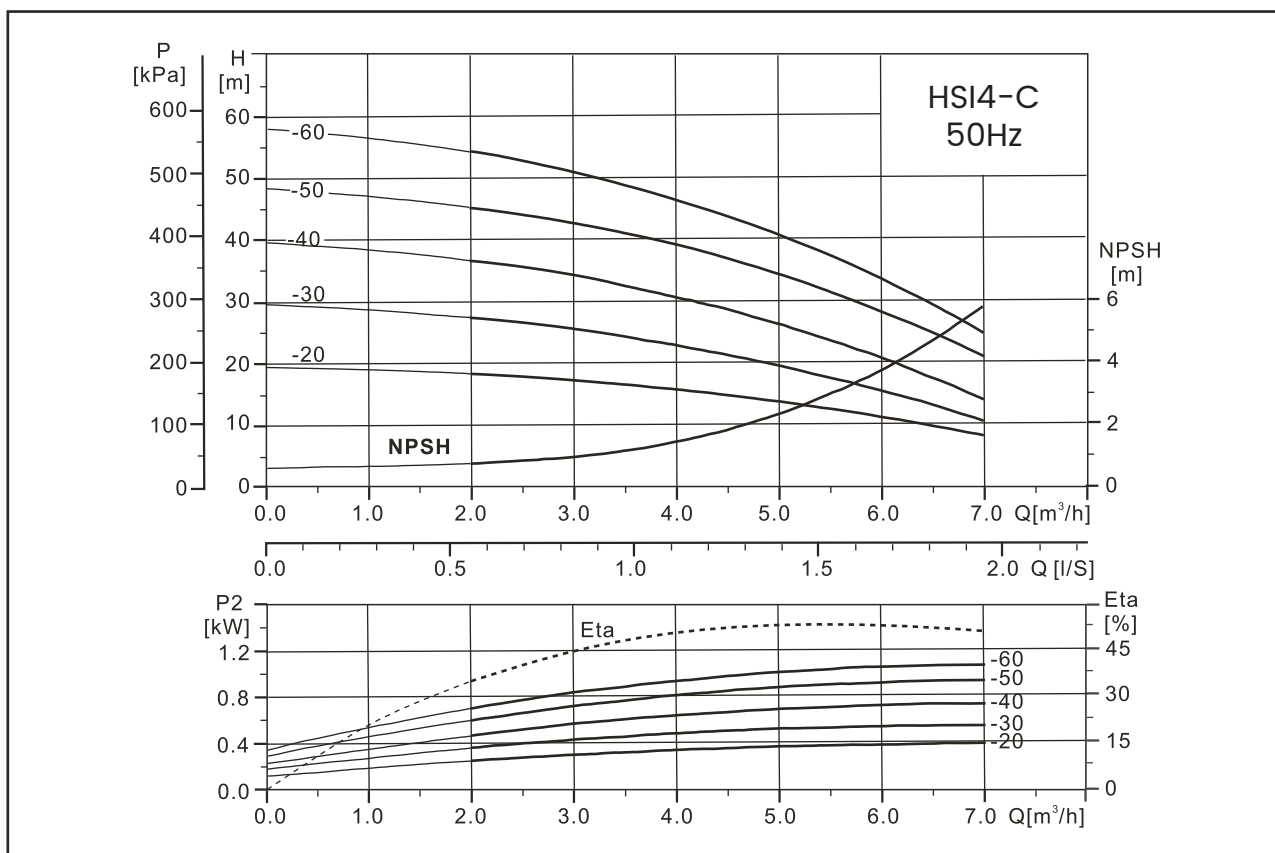

Performance Table

MODEL	Driving motor P ₂ (kW)	Q (m³/h)	2.0	3.0	4.0	5.0	6.0	7.0
HSI4-20C	0.55	H (m)	18	16	15	13	10	7
HSI4-30C	0.75		27	25	22	19	15	10
HSI4-40C	0.75		36	33	30	26	20	13
HSI4-50C	1.0		44	41	38	32	26	20
HSI4-60C	1.1		53	50	45	40	33	24

Dimension & Weight

MODEL	SIZE (mm)								Weight (kg)
	Single Phase				Three Phase				
	L1	L2	L3	H	L1	L2	L3	H	
HSI4-20C	342	103	92	189	342	103	92	192	9
HSI4-30C	360	121	110	189	360	121	110	192	10
HSI4-40C	378	139	128	189	378	139	128	192	11
HSI4-50C	396	157	146	215	396	157	146	192	12
HSI4-60C	414	175	164	215	414	175	164	192	13

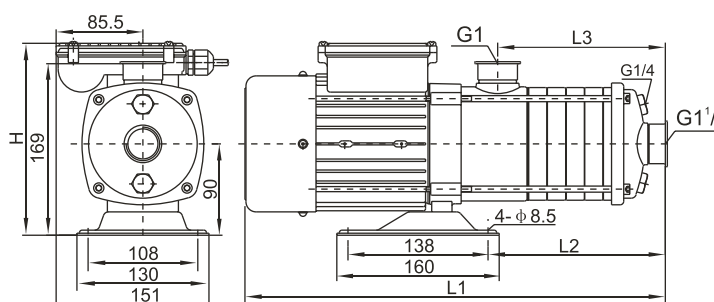

Technical Data (HSI8-C)

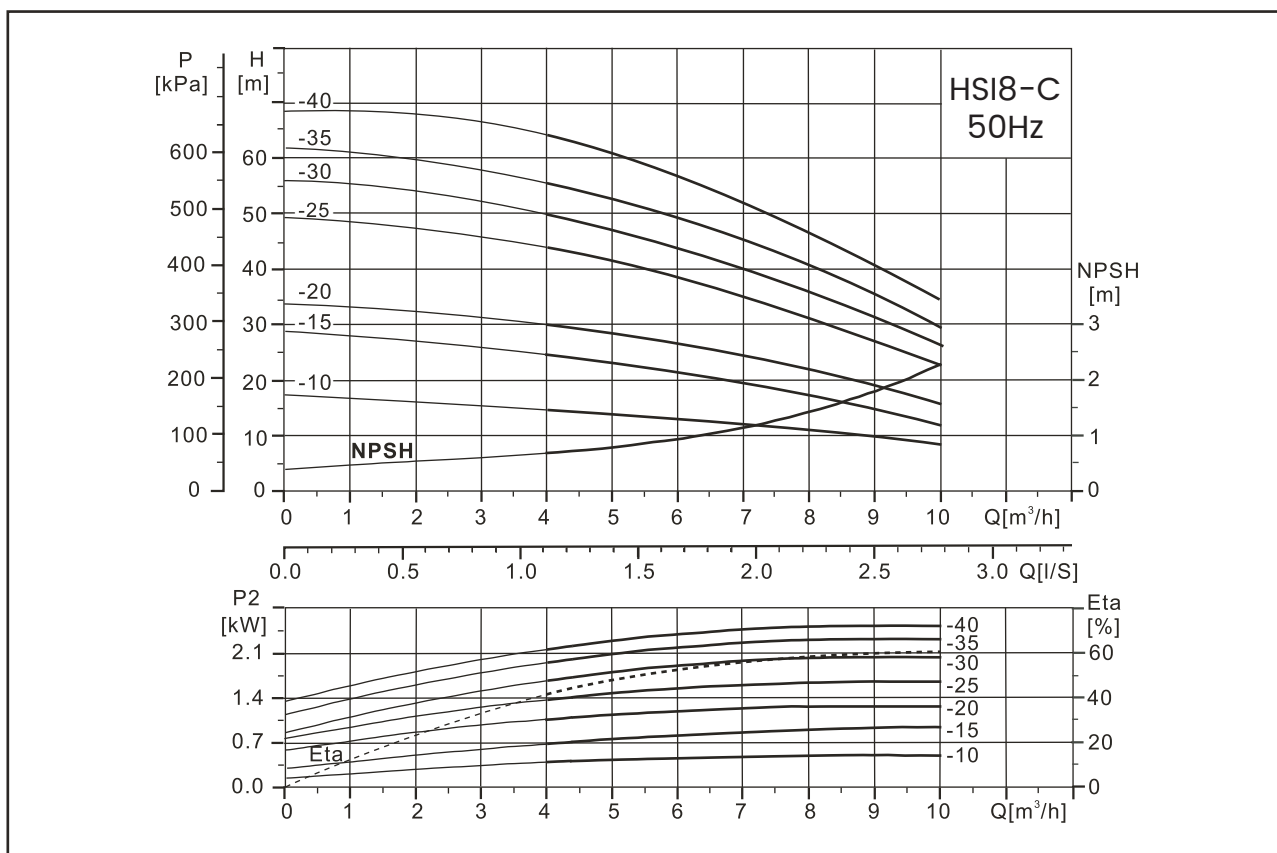

Performance Table

MODEL	Driving motor P ₂ (kW)	Q (m³/h)	4.0	5.0	6.0	7.0	8.0	9.0	10
HSI8-10C	0.55	H (m)	15	14	13	12.5	12	9	8
HSI8-15C	0.75		25	23	22	21	20	14	12
HSI8-20C	1.0		32	29	27	25	24	21	17
HSI8-25C	1.5		43	40	38	34	27	25	20
HSI8-30C	1.85		50	46	44	40	36	30	26
HSI8-35C	2.2		56	51	48	44	43	35	28
HSI8-40C	2.2		65	57.5	57	50	48	42	34

Dimension & Weight

MODEL	SIZE (mm)										Weight (kg)
	Single Phase					Three Phase					
	L1	L2	L3	H	B	L1	L2	L3	H	B	
HSI8-10C	340	144	83	227	163	340	144	83	220	163	13
HSI8-15C	370	175	113	227	163	370	175	113	220	163	15
HSI8-20C	370	175	113	227	163	370	175	113	220	163	18
HSI8-25C	432	205	144	235	163	432	205	144	225	163	20
HSI8-30C	474	205	144	262	168	432	205	144	225	163	25
HSI8-35C	504	235	174	262	168	463	235	174	225	163	26
HSI8-40C	504	235	174	262	168	463	235	174	225	163	28

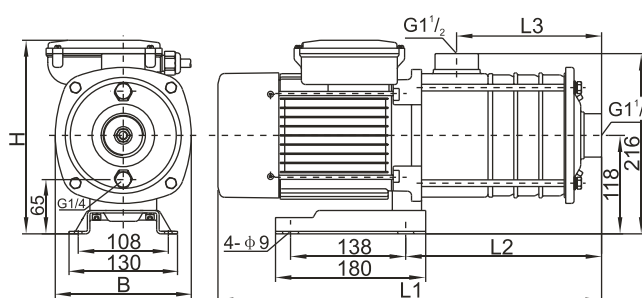

Technical Data (HSI8-BC)

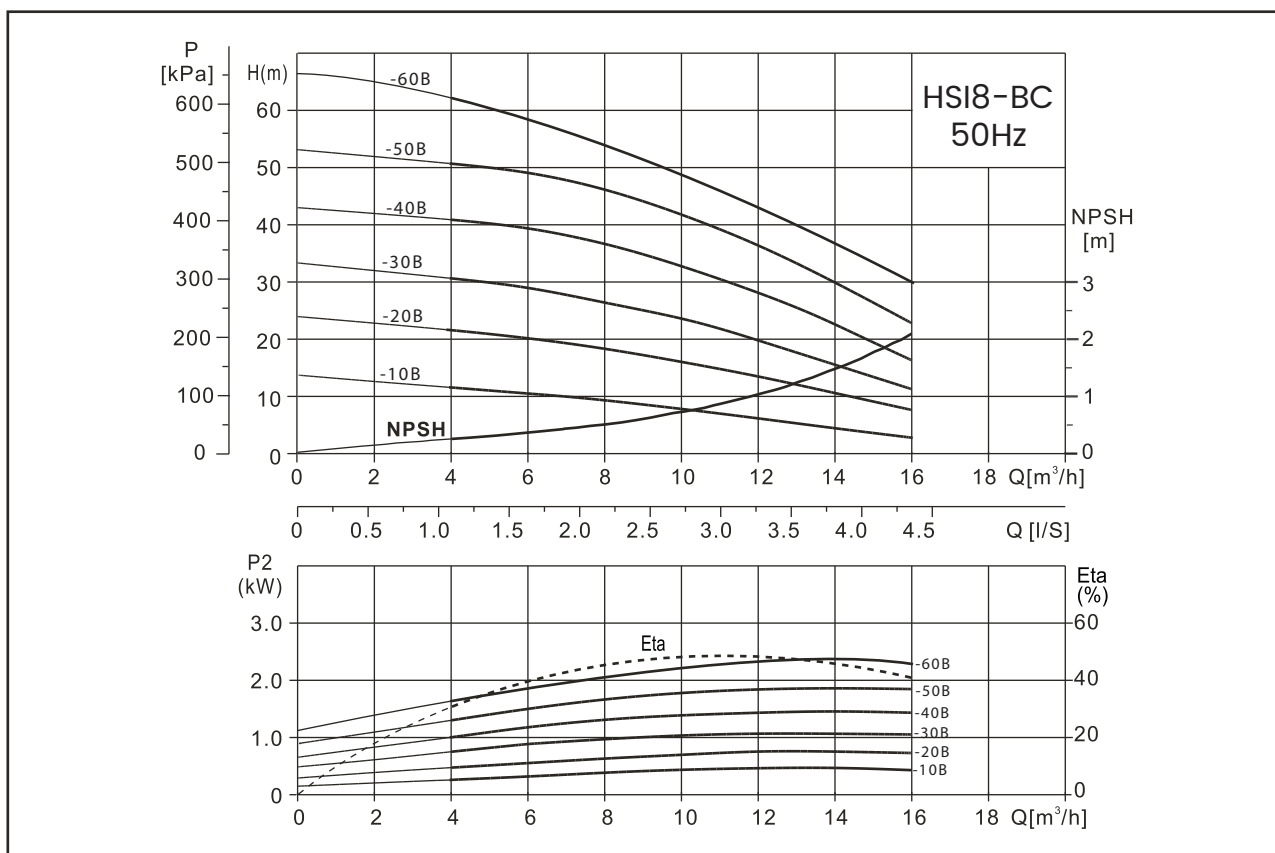

Performance Table

MODEL	Driving motor P ₂ (kW)	Q (m³/h)	4.0	6.0	8.0	10	12	14	16
HSI8-10BC	0.55	H (m)	11	10	9	8	7	6	5
HSI8-20BC	0.75		22	20	19	18	13	11	8
HSI8-30BC	1.1		31	29	26	24	20	16	11
HSI8-40BC	1.5		41	39	37	33	28	23	17
HSI8-50BC	2.2		51	49	46.5	42	37	30	23
HSI8-60BC	3.0		62	58	52	48	42	36	30

Dimension & Weight

MODEL	SIZE (mm)										Weight (kg)
	Single Phase					Three Phase					
	L1	L2	L3	H	B	L1	L2	L3	H	B	
HSI8-10BC	340	144	83	227	163	340	144	83	220	163	14
HSI8-20BC	370	175	113	227	163	370	175	113	220	163	15
HSI8-30BC	432	205	144	235	163	432	205	144	225	163	19
HSI8-40BC	463	235	174	235	16	463	235	174	225	163	20
HSI8-50BC	534	265	204	262	168	493	265	204	225	163	28
HSI8-60BC	—	—	—	—	—	584	296	234	230	168	31

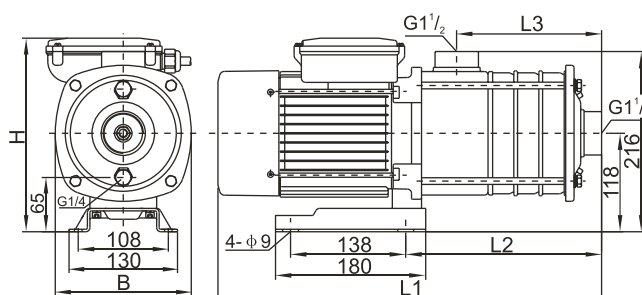

Technical Data (HSI12-C)

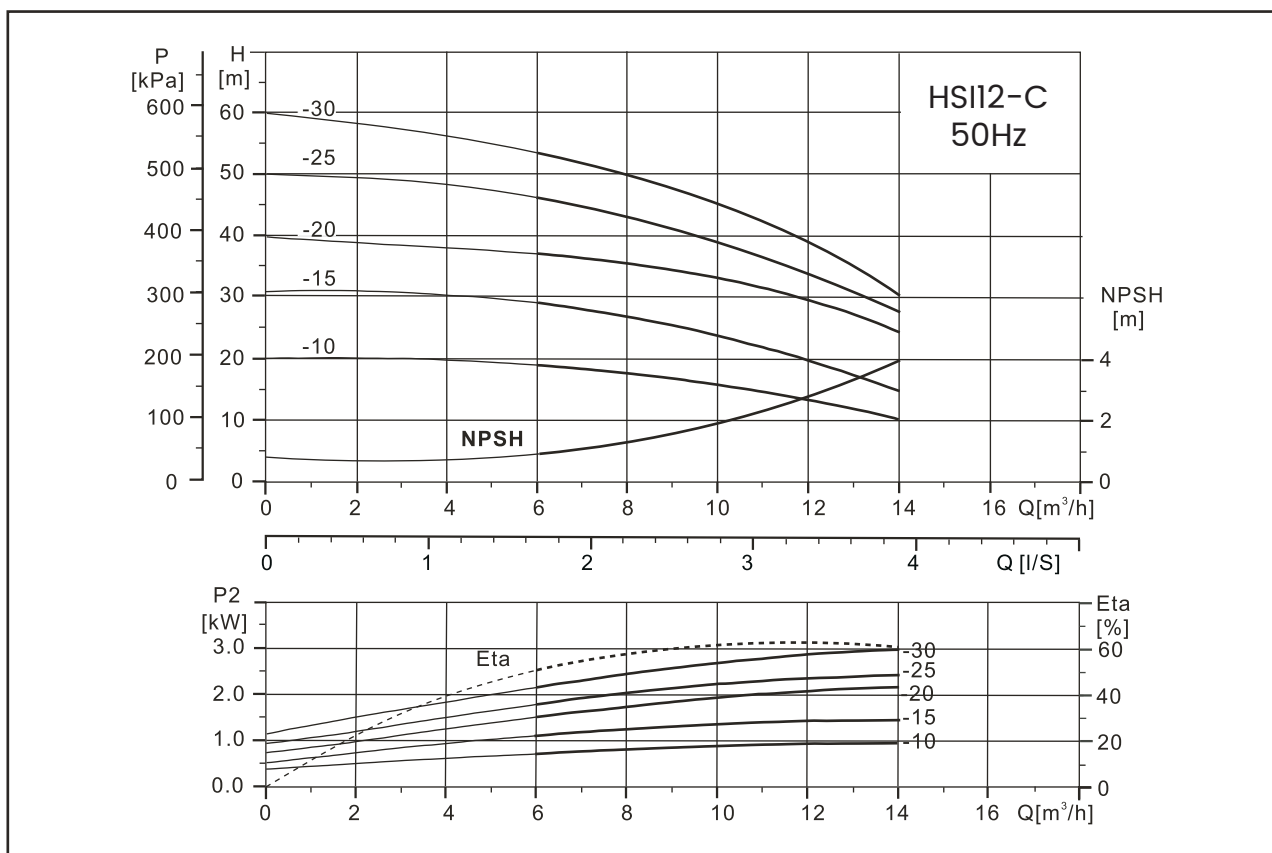

Performance Table

MODEL	Driving motor P ₂ (kW)	Q (m³/h)	6.0	7.0	8.0	9.0	10	11	12	13	14
HSI12-10C	1.0	H (m)	19	18	17.5	16	15.5	14	13.5	12	10.5
HSI12-15C	1.5		28	27	26	25	24	22	20	18	15
HSI12-20C	1.85		38	36	35	32	31	29	28	24	20
HSI12-25C	2.2		47	45	43	41.5	39	36	33.5	30.5	27
HSI12-30C	3.0		53.5	52	50	47.5	45	42	39	35	30

Dimension & Weight

MODEL	SIZE (mm)										Weight (kg)
	Single Phase					Three Phase					
	L1	L2	L3	H	B	L1	L2	L3	H	B	
HSI12-10C	340	144	83	227	163	340	144	83	220	163	14
HSI12-15C	402	175	113	235	163	402	175	113	225	163	16
HSI12-20C	444	175	113	262	168	444	175	113	225	163	24
HSI12-25C	474	205	144	262	168	474	205	144	225	163	26
HSI12-30C	—	—	—	—	—	494	205	144	230	168	28

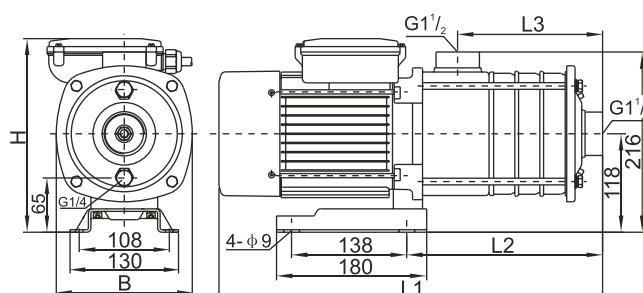

Technical Data (HSI12-BC)

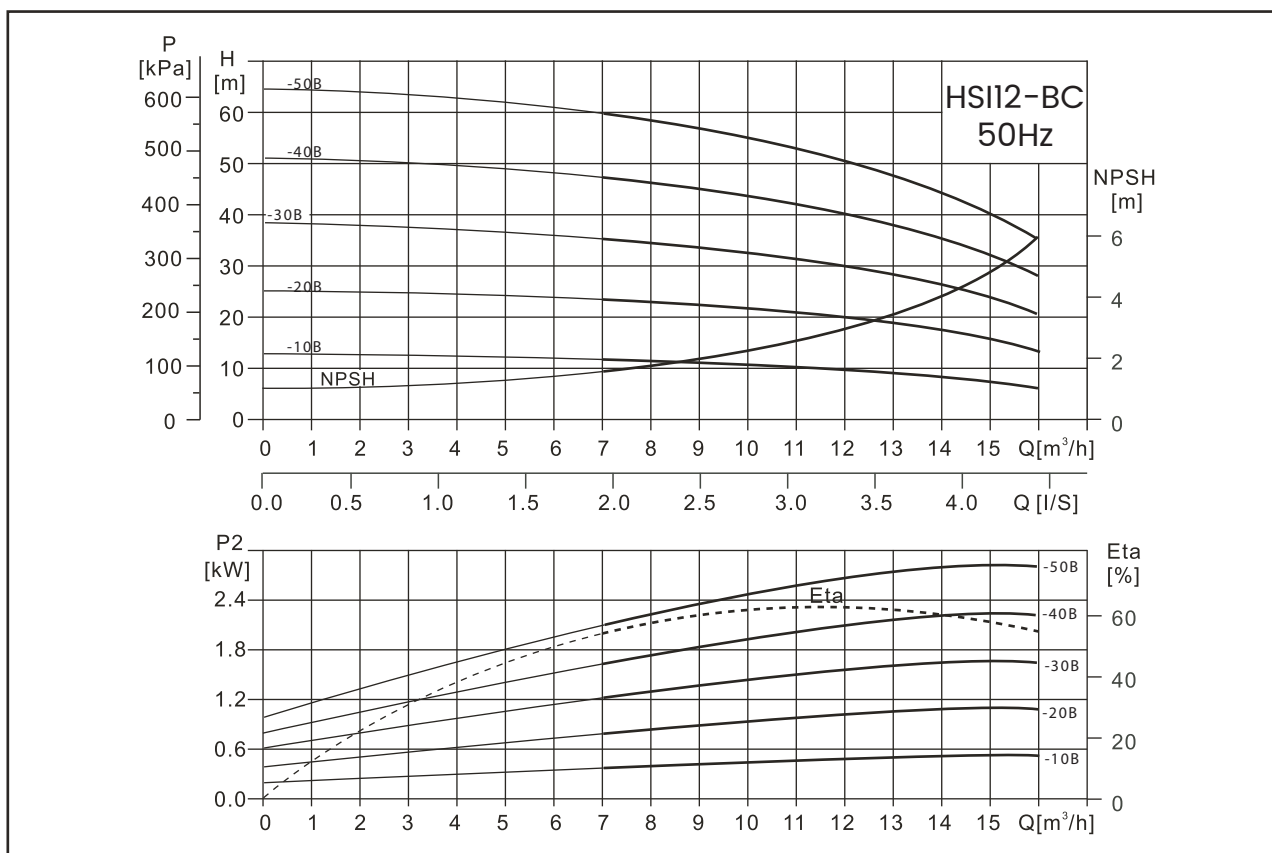

Performance Table

MODEL	Driving motor P ₂ (kW)	Q (m³/h)	7.0	8.0	9.0	10	11	12	13	14	15	16
HSI12-10BC	0.75	H (m)	12	11.5	11	10.5	10	9.5	9	8	7	6
HSI12-20BC	1.1		23	22.5	22	21	20.5	19.5	18.5	17	15.5	13
HSI12-30BC	1.85		35	34.5	33.5	32.5	31	29.5	28	26	23.5	20
HSI12-40BC	2.2		47	46	45	43.5	41.5	39.5	37.5	35	31.5	27.5
HSI12-50BC	3.0		60	58	56.5	55	52.5	50	47	44	40	35

Dimension & Weight

MODEL	SIZE (mm)										Weight (kg)
	Single Phase					Three Phase					
	L1	L2	L3	H	B	L1	L2	L3	H	B	
HSI12-10BC	340	144	83	227	163	340	144	83	220	163	13
HSI12-20BC	402	175	113	235	163	402	175	113	225	163	15
HSI12-30BC	474	205	144	262	168	432	205	144	225	168	26
HSI12-40BC	504	235	174	262	168	462	235	174	225	168	28
HSI12-50BC	—	—	—	—	—	554	265	204	230	168	31

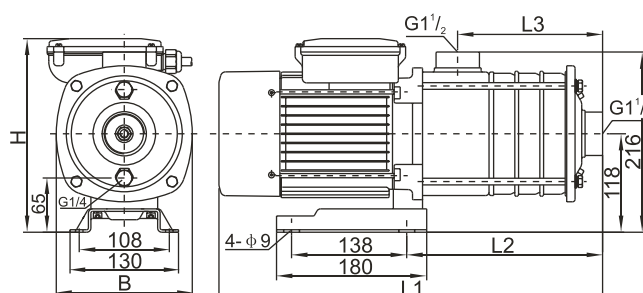

Technical Data (HSI16-C)

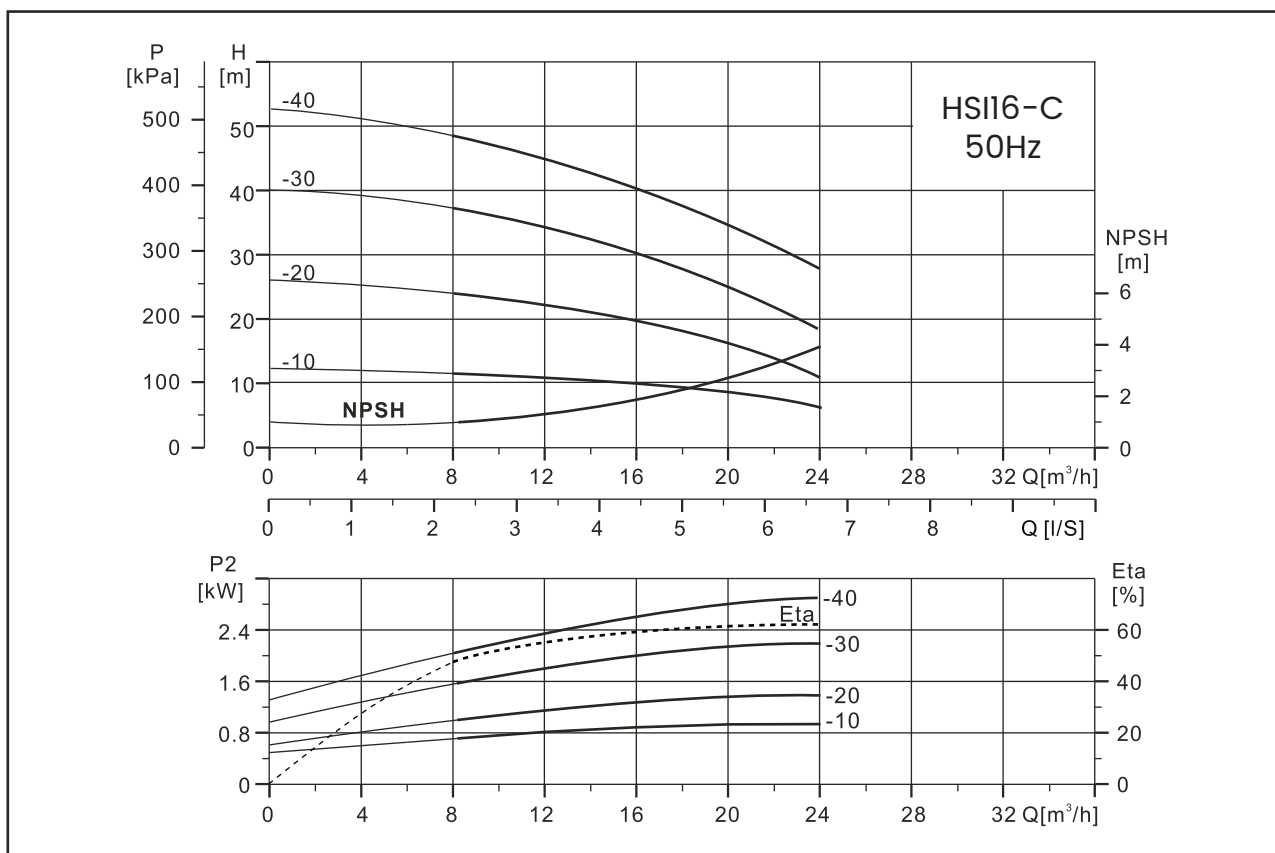

Performance Table

MODEL	Driving motor P ₂ (kW)	Q (m³/h)	8	10	12	14	16	18	20	22	24
HSI16-10C	1.0	H (m)	12	11.5	11	10.5	10	9	8	7	6
HSI16-20C	1.5		24	23	22	21	20	19	16	14	12
HSI16-30C	2.2		38	36	34	33	30	28	26	23	20
HSI16-40C	3.0		50	48	46	44	40	38	36	32	28

Dimension & Weight

MODEL	S I Z E (mm)										Weight (kg)
	Single Phase					Three Phase					
	L1	L2	L3	H	B	L1	L2	L3	H	B	
HSI16-10C	354	158	90	227	163	354	158	90	220	163	13
HSI16-20C	431	204	136	235	163	431	204	136	225	163	19
HSI16-30C	518	249	181	262	168	518	249	181	230	168	26
HSI16-40C	—	—	—	—	—	563	294	226	230	168	29

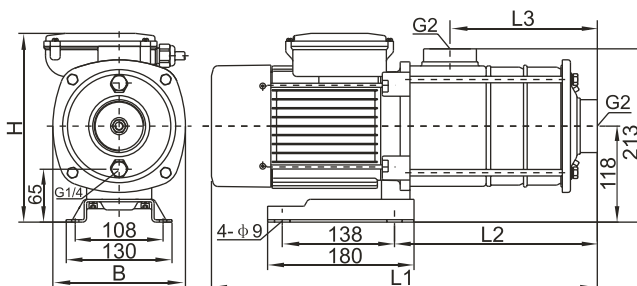

Technical Data (HSI20-C)

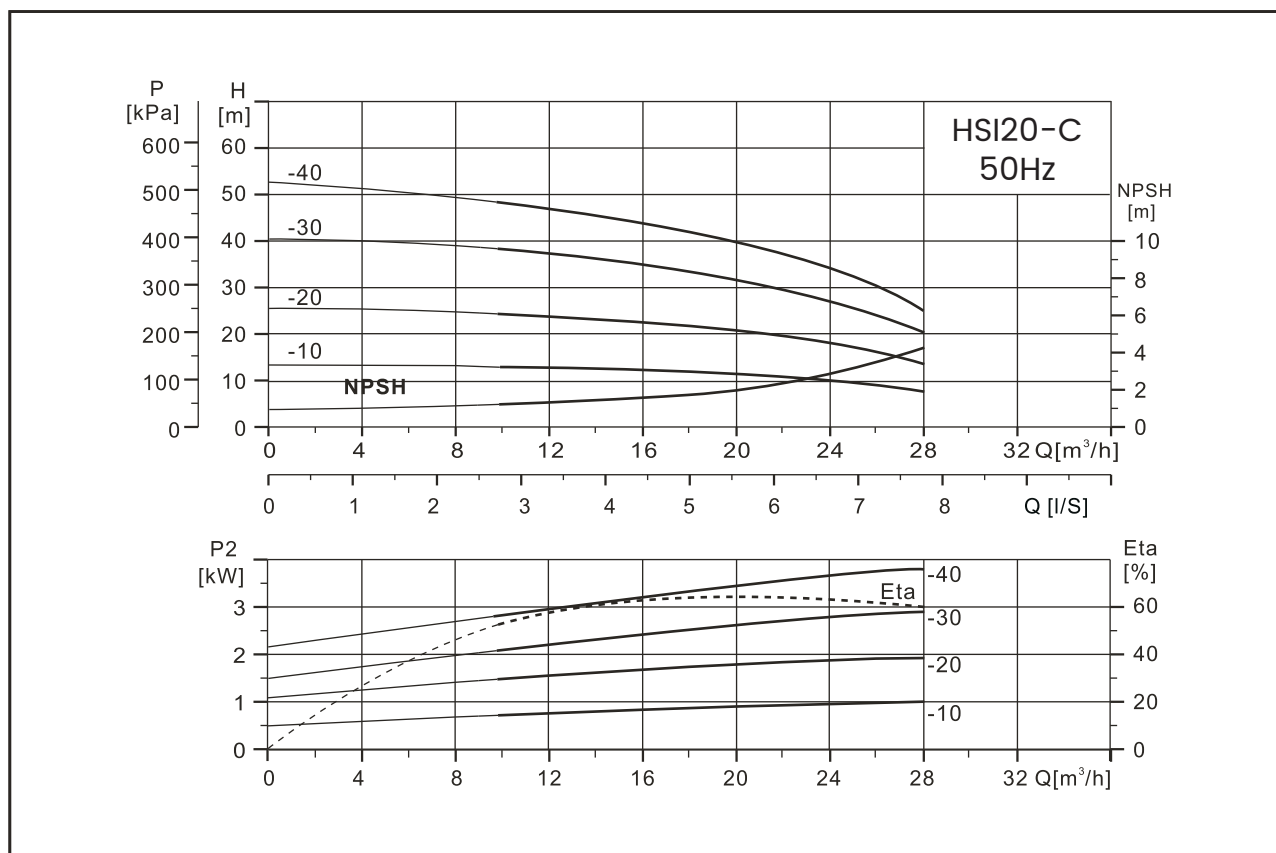

Performance Table

MODEL	Driving motor P ₂ (kW)	Q (m³/h)	10	12	14	16	18	20	22	24	26	28
HSI20-10C	1.0	H (m)	13	12.5	12	11.5	11	10.5	10	9	8.5	7.5
HSI20-20C	1.85		25	24	23	22	21	20	18	16	14	12
HSI20-30C	3.0		39	38	36	35	33	31.5	30	27	24	21
HSI20-40C	4.0		50	48	46	44	42	40	36	32	28	24

Dimension & Weight

MODEL	SIZE (mm)												Weight (kg)
	L2	L3	M	J	H1	H2	Single Phase			Three Phase			
							H	L1	B	H	L1	B	
HSI20-10C	158	90	108	138	118	213	245	354	163	220	354	163	15
HSI20-20C	204	136	108	138	118	213	262	472	168	225	431	163	25
HSI20-30C	249	181	108	138	118	213	—	—	—	230	538	168	29
HSI20-40C	338	226	190	140	132	227	—	—	—	279	602	190	34

