



PISO Series



End Suction Centrifugal Pumps

Catalogue

www.met.com.my



SHINDO HAS CONSTANTLY DEVELOP THE CREDIBILITY TO SERVE THE INDUSTRY EFFICIENTLY.

SHINDO IS COMMITTED TO PROVIDE HIGH VALUE-ADDED PRODUCTS IN MINIMUM LEAD-TIME AND AT COST EFFECTIVE PRICING, TO HELP CUSTOMERS ACHIEVE ZERO DOWNTIME, PRODUCTION TARGET AND HELP ENHANCE A SAFER ENVIRONMENT.



PISO SERIES

END SUCTION CENTRIFUGAL PUMPS

PAGE CONTENTS

01	APPLICATION MODEL CODE
02	CONSTRUCTION DESIGN
03	CONSTRUCTION DESIGN (CONT.)
04	GENERAL ARRANGEMENT DRAWING
05	SELECTION CHART
06	DIMENSIONAL DRAWING
07	DIMENSIONAL DRAWING (CONT.)

Application

Shindo End Suction Centrifugal Pumps, PISO Series can be used in commercial, residential, agriculture, industrial processing, petroleum, and food & beverage industries. Specifically, PISO Series pumps are design for following applications:

- ✕ HVAC System
- ✕ Cooling Towers System
- ✕ Fire Fighting System
- ✕ Circulation System
- ✕ Water Pressure Boosting System
- ✕ Domestic Water Supply
- ✕ Water & Sea Water Treatment
- ✕ Refrigeration
- ✕ Chemical
- ✕ Irrigation

Performance range for PISO series:

- ✕ Max. Capacity (Q) = 1944m³/hr
- ✕ Max. Head (H) = 160m
- ✕ Max. Operating Pressure = 16 bar
- ✕ Max. Liquid Temperature = +120°C



Model Code

PISO 150 X 125 - 500

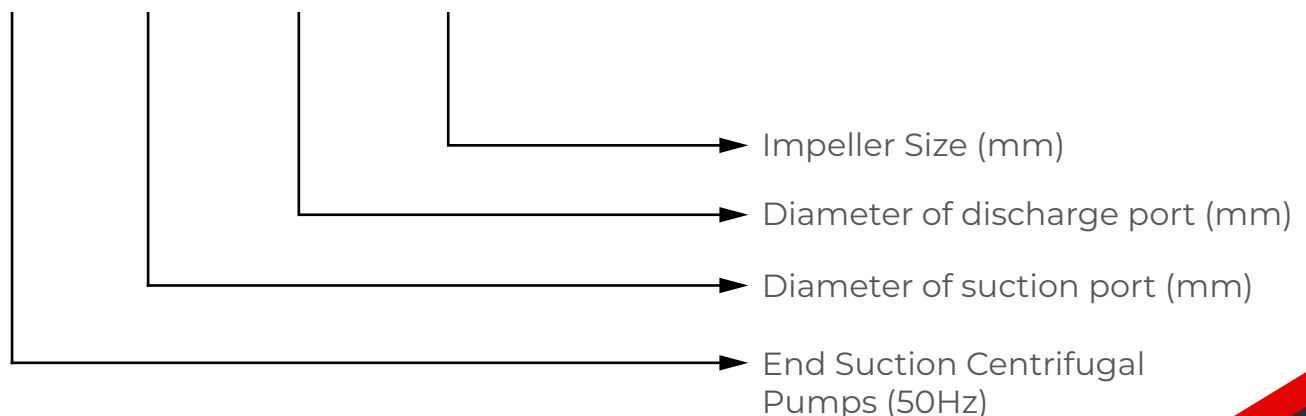

Construction Design

Shindo PISO series are in compliance with ISO standard ISO2858/5199 which covers all sizes of the pumps. They are design with axial suction and vertical discharge in which the connections are flange type for both suction and discharge. The suction and discharge flanges are accordance with EN1092. The pump has back pull-out design, and when a suitable spacer coupling is fitted to a direct coupled unit, the casing and motor can remain in position while other pump parts can be removed for simple and quick maintenance.

Hydraulic Parts

- α Casing is made up of cast iron.
 - α Impeller is made up of stainless steel (SS304).
 - α Shaft is made up of stainless steel (SS420).
 - α The standard material of mechanical seal is Ceramic/Graphite/NBR.
- Note: 1. Impeller made up of bronze is also available on request.*
2. Fully stainless steel (SS304 or SS316) for wetted parts are also available on request.

Electric Motor

- α IEC standard.
- α Insulation Class: F
- α Enclosure Class: IP55
- α Speed: 1450RPM/2900RPM
- α Standard Voltage: 3 x 380-415V, 50Hz

Material of Mechanical Seal

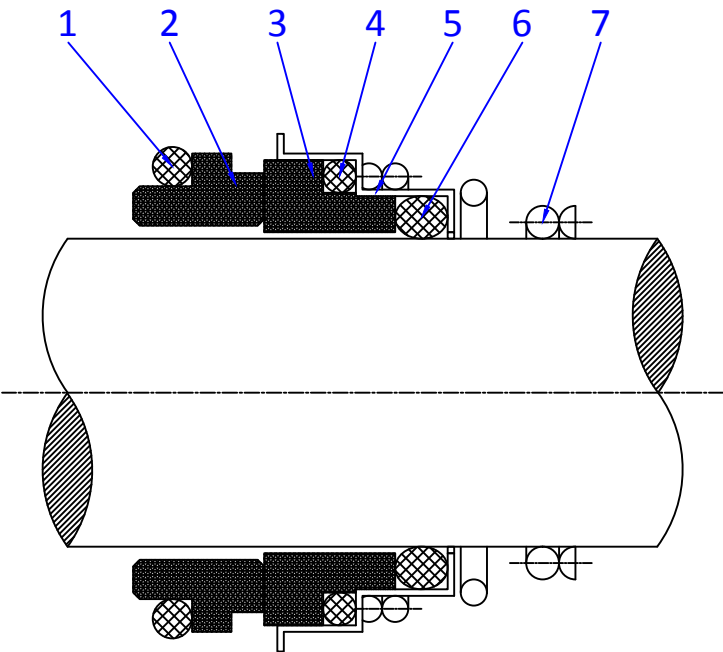

No.	Name	Qty	Material
1	O-Ring	1	NBR
2	Stationary Seats	1	Ceramic
3	Seal Faces	1	Graphite
4	O-Ring	1	NBR
5	Seal Faces Base	1	Stainless Steel
6	O-Ring	1	NBR
7	Spring	1	Stainless Steel

Casing

Self-venting horizontal volute casing with horizontal suction and vertical discharge. The suction nozzle has a vane to reduce prerotation.

Shaft

Tapered and keyed shaft design allowing ease of removal during maintenance and positive locking whilst in operation.

Shaft Seal

Single, high quality mechanical seal fitted as standard to all pumps.

Bearing

Heavy duty NSK or approved equivalent. Greased for life, reducing maintenance. Protected by a quality manufactured lip seal and reducing ingress of moisture or foreign matter. Housed within removable bearing cap cover assembly.

Bearing Housing

Robust/heavy duty, manufactured in high strength cast iron providing trouble-free life complete with lifting provision and support foot.

General Arrangement Drawing

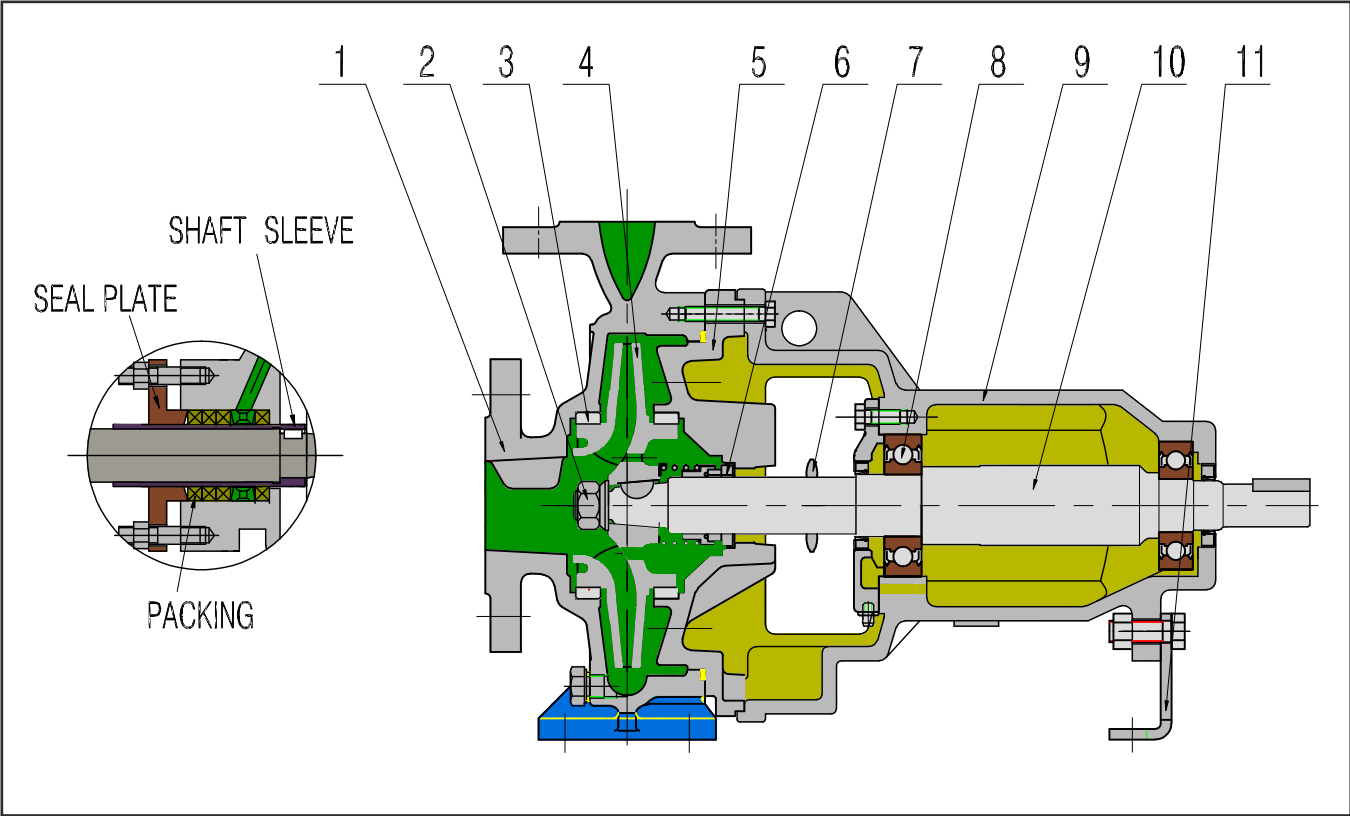

Part No.	Name
1	Volute Casing
2	Impeller Nut
3	Wear Ring
4	Impeller
5	Casing Cover
6	Shaft Sleeve
7	Packing/Mechanical Seal
8	Slinger
9	Bearing
10	Bearing Housing
11	Shaft
12	Support Foot

Selection Chart

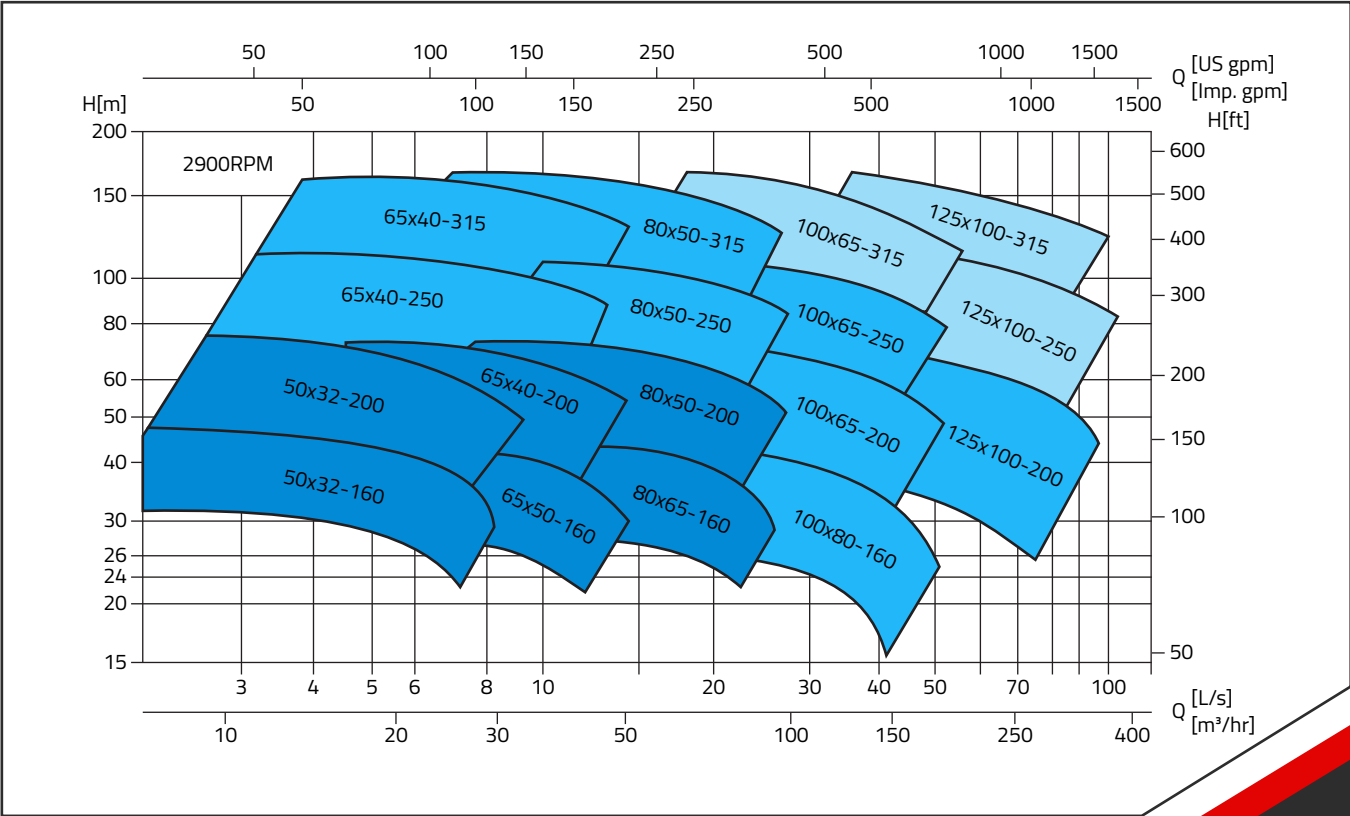
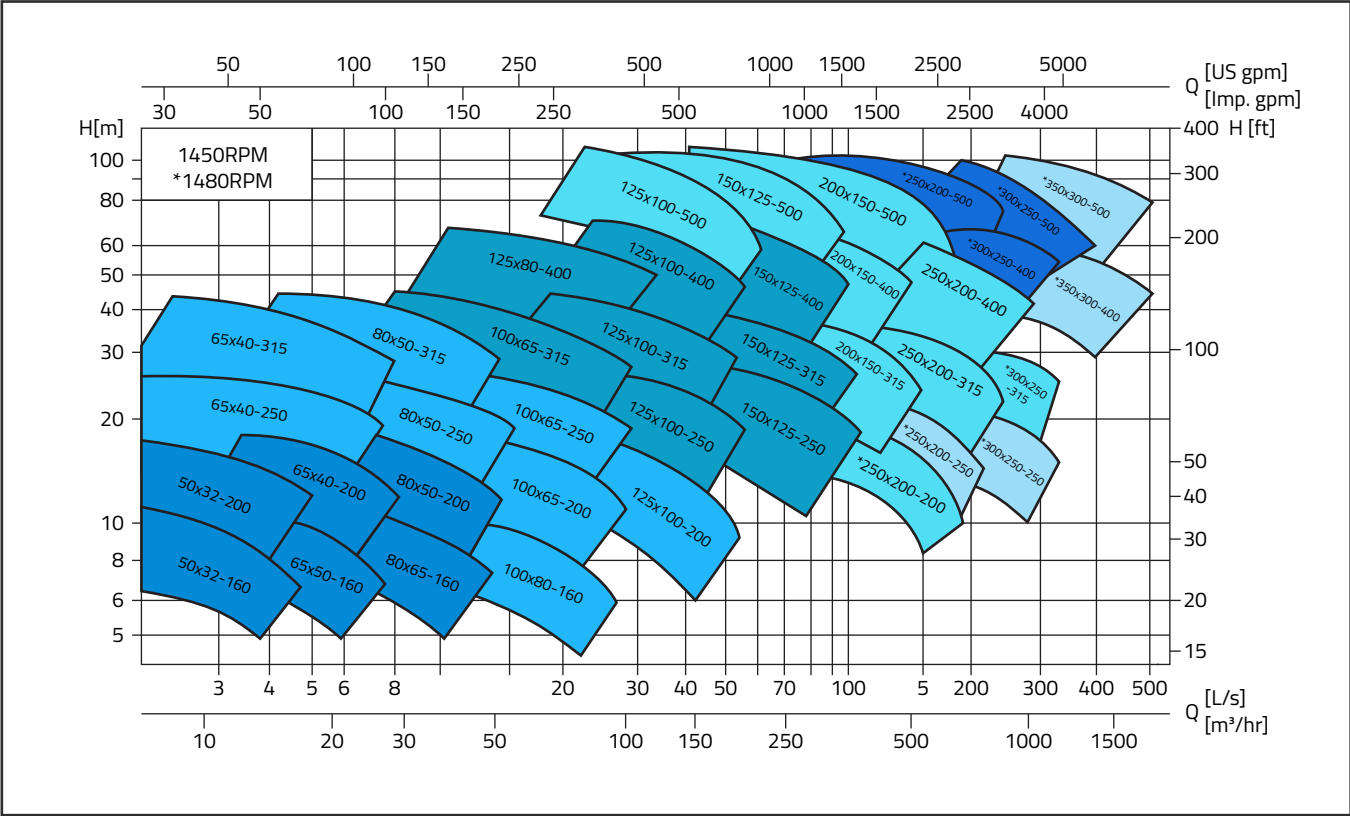

Dimensional Drawing

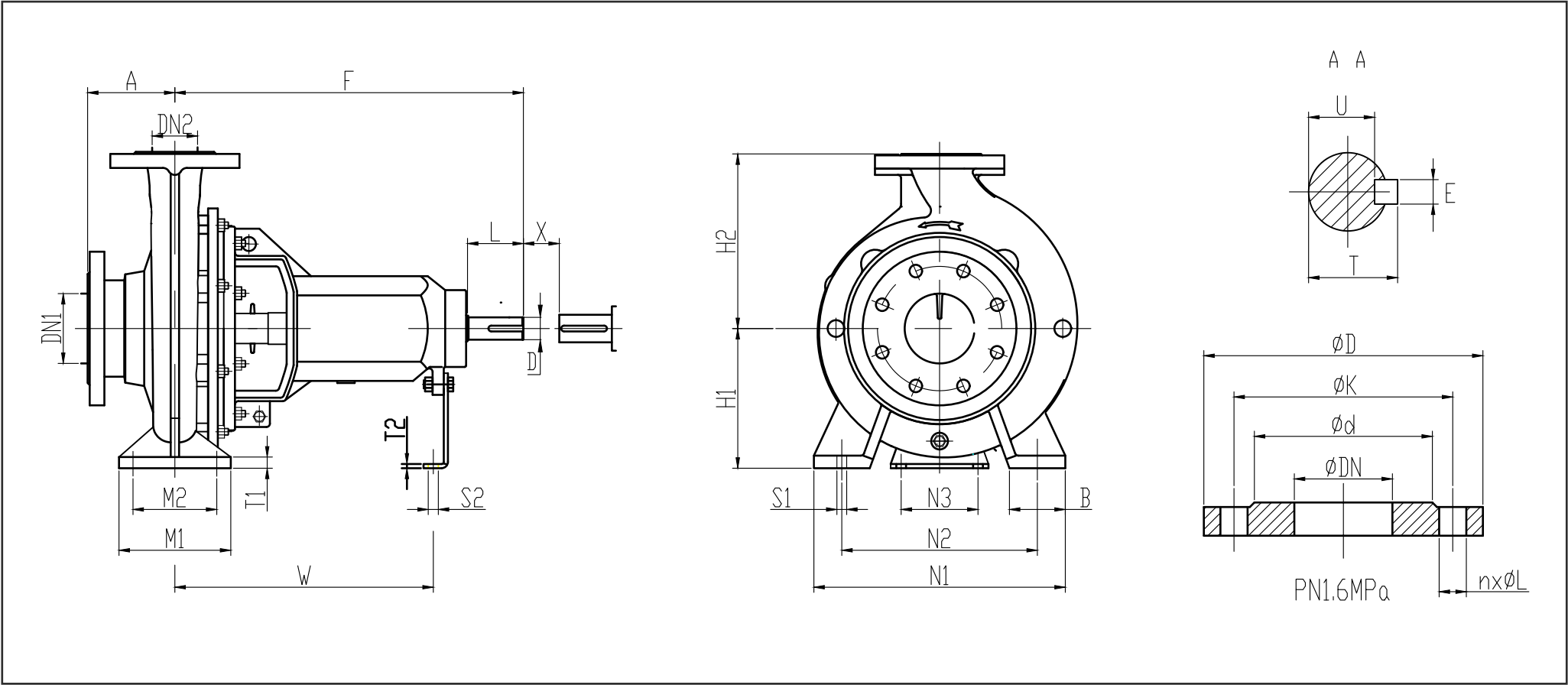

Pump Model	Shaft No.	Flange Size		Pump Dimensions				Foot Dimensions								Bolt Holes		Shaft End					Spacer X ≥	Net Weight (kg)	
		DN1	DN2	A	F	H1	H2	B	M1	M2	N1	N2	N3	W	T1	T2	S1	S2	D	L	T	E			U
PISO50X32-160	1	50	32	80	385	132	160	50	100	70	240	190	110	285	12	6	M12	M12	24	50	27	8	20	100	38
PISO50X32-200	1	50	32	80	385	160	180	50	100	70	240	190	110	285	12	6	M12	M12	24	50	27	8	20	100	46
PISO65X40-200	1	65	40	100	385	160	180	50	100	70	265	212	110	285	13	6	M12	M12	24	50	27	8	20	100	48
PISO65X40-250	2	65	40	100	500	180	225	65	125	95	320	250	110	370	14	6	M12	M12	32	80	35	10	27	100	70
PISO65X40-315	2	65	40	125	500	200	250	65	125	95	345	280	110	370	16	6	M12	M12	32	80	35	10	27	100	80
PISO65X50-160	1	65	50	80	385	132	160	50	100	70	240	190	110	285	11	6	M12	M12	24	50	27	8	20	100	40
PISO80X50-200	1	80	50	100	385	160	200	50	100	70	265	212	110	285	13	6	M12	M12	24	50	27	8	20	100	52
PISO80X50-250	2	80	50	125	500	180	225	65	125	95	320	250	110	370	15	6	M12	M12	32	80	35	10	27	100	72
PISO80X50-315	2	80	50	125	500	225	280	65	125	95	345	280	110	370	18	6	M12	M12	32	80	35	10	27	100	87
PISO80X65-160	1	80	65	100	385	160	180	50	100	70	265	212	110	285	11	6	M12	M12	24	50	27	8	20	100	46
PISO100X65-200	2	100	65	100	500	180	225	65	125	95	320	250	110	370	14	6	M12	M12	32	80	35	10	27	140	70
PISO100X65-250	2	100	65	125	500	200	250	80	160	120	360	280	110	370	16	6	M16	M12	32	80	35	10	27	140	80
PISO100X65-315	3	100	65	125	530	225	280	80	160	120	400	315	110	370	18	6	M16	M12	42	110	45	12	37	140	118
PISO100X80-160	2	100	80	100	500	160	200	65	125	95	280	212	110	370	14	6	M12	M12	32	80	35	10	27	100	68
PISO125X80-400	3	125	80	125	530	280	355	80	160	120	435	355	110	370	20	6	M16	M12	42	110	45	12	37	140	165
PISO125X100-200	2	125	100	125	500	200	280	80	160	120	360	280	110	370	17	6	M16	M12	32	80	35	10	27	140	85
PISO125X100-250	3	125	100	140	530	225	280	80	160	120	400	315	110	370	18	6	M16	M12	42	110	45	12	37	140	126
PISO125X100-315	3	125	100	140	530	250	315	80	160	120	400	315	110	370	19	6	M16	M12	42	110	45	12	37	140	135
PISO125X100-400	3	125	100	140	530	280	355	100	200	150	500	400	110	370	20	6	M20	M12	42	110	45	12	37	140	175
PISO125X100-500	4	125	100	160	670	355	450	100	200	150	550	450	110	500	25	10	M20	M16	48	110	51.5	14	42.5	180	313
PISO150X125-250	3	150	125	140	530	250	355	80	160	120	400	315	110	370	19	6	M16	M12	42	110	45	12	37	140	140
PISO150X125-315	3	150	125	140	530	280	355	100	200	150	500	400	110	370	20	6	M20	M12	42	110	45	12	37	140	150
PISO150X125-400	3	150	125	140	530	315	400	100	200	150	500	400	110	370	21	6	M20	M12	42	110	45	12	37	140	186
PISO150X125-500	4	150	125	160	670	355	450	100	200	150	550	450	140	500	25	10	M20	M16	48	110	51.5	14	42.5	180	336
PISO200X150-315	4	200	150	160	670	315	400	100	200	150	550	450	140	500	25	10	M20	M16	48	110	51.5	14	42.5	180	222
PISO200X150-400	4	200	150	160	670	315	450	100	200	150	550	450	140	500	25	10	M20	M16	48	110	51.5	14	42.5	180	300
PISO200X150-500	4	200	150	160	670	400	500	100	200	150	550	450	140	500	25	10	M20	M16	48	110	51.5	14	42.5	180	382
PISO250X200-200	4	250	200	180	670	315	450	100	200	150	550	450	140	500	22	10	M20	M16	48	110	51.5	14	42.5	180	345
PISO250X200-250	5	250	200	180	885	315	450	100	200	150	550	450	180	670	25	12	M24	M16	65	140	69	18	58	250	490
PISO250X200-315	4	250	200	180	670	315	450	100	200	150	550	450	140	500	25	10	M20	M16	48	110	51.5	14	42.5	180	277
PISO250X200-400	4	250	200	180	670	355	500	100	200	150	550	450	140	500	25	10	M20	M16	48	110	51.5	14	42.5	180	340
PISO250X200-500	5	250	200	225	885	400	580	150	315	250	760	630	180	670	28	12	M24	M16	65	140	69	18	58	250	495
PISO300X250-250	5	300	250	225	885	355	560	125	250	190	630	500	180	670	24	12	M24	M16	65	140	69	18	58	250	360
PISO300X250-315	4	300	250	225	670	355	500	125	250	190	690	560	180	500	24	12	M20	M16	48	110	51.5	14	42.5	180	350
PISO300X250-400	5	300	250	225	885	450	560	150	250	190	690	560	180	670	28	12	M24	M16	65	140	69	18	58	250	480
PISO300X250-500	5	300	250	225	885	450	630	150	315	250	760	630	180	670	28	12	M24	M16	65	140	69	18	58	250	530
PISO350X300-400	6	350	300	250	975	450	600	180	315	250	760	630	180	730	24	12	M24	M16	75	170	79.5	20	67.5	250	900
PISO350X300-500	6	350	300	250	975	500	650	225	360	270	900	750	180	730	32	12	M30	M16	75	170	79.5	20	67.5	250	1100

**All dimensions are in mm unless specified

Standard Flange: GB/T 17241.6-1998(ISO7005.2:1988), PN1.6MPa												
DN	32	40	50	65	80	100	125	150	200	250	300	350
Ød	76	84	99	118	132	156	184	211	266	319	370	429
ØK	100	110	125	145	160	180	210	240	295	355	410	470
ØD	140	150	165	185	200	220	250	285	340	405	460	520
nxØL	4 x Ø18	4 x Ø18	4 x Ø18	4 x Ø18	8 x Ø18	8 x Ø18	8 x Ø18	8 x Ø22	12 x Ø22	12 x Ø26	12 x Ø26	16 x Ø26

